



PRECISION SLIDE PRODUCTS

designed for commercial, residential, & institutional applications



Accuride[®]
Always Moving Forward



Accuride®

Always Moving Forward

Accuride International made its start in 1962 as a small tool and die shop designing and manufacturing ball bearing slides for the electromechanical industry. Today, still privately held, the company has grown to encompass nearly one million square feet of manufacturing space in six locations around the world. Earning a reputation as an expert in the development of movement solutions, over the years Accuride has designed access, positioning, and motion into a diverse range of applications.

Accuride's test laboratory is among the largest in the industry. Products are tested to meet or exceed standards established by ANSI, BHMA, and other testing agencies.

Accuride was the first U.S. based slide manufacturer awarded ISO 9001 certification. Today, all our production facilities have quality management systems registered to ISO 9001:2008.



As a part of Accuride's global commitment to adhering to local environmental laws (even exceeding the standards, whenever practical), using raw materials efficiently, and reducing waste, all slide finishes and components comply with the Restriction of Hazardous Substances (RoHS) Directive. Most Accuride slides are manufactured with up to 35% recycled steel.



FOLLOW US!

Yes, we've jumped on the social media bandwagon and we'd love to have you join us. We've set up market-specific pages so you can follow (and comment on) the information most meaningful to you.

Facebook: <http://bit.ly/accuridearch>

Twitter: <http://twitter.com/accuridearch>



PRECISION SLIDE PRODUCTS

Technical Information	2
Slide Selection Criteria	
Specs at a Glance	4
Light-Duty Slide	6
2632	
Medium-Duty Slides	7
3832 Family, 3132 Eclipse, 7432/7434	
Heavy-Duty Slides	9
400 Series, 3641, 3640A, 7950, 7957, 9301	
Media Access Products	12
Ascent Mechanical Lift M.A.C. Systems	
Flipper Door Slides®	14
1155, 1321 Pro Pocket, 1332/1432	
Specialty Slides	16
2006, 2109, 0363, 301-2590, 3600-200, 3600-201	
Limited Lifetime Warranty	19



SLIDE SELECTION CRITERIA

This abbreviated catalog is designed to simplify slide selection by featuring the most commonly specified slides. To view the entire product line, visit our web site at www accuride.com, where you will also find specification recommendations, CAD drawings, and detailed technical information.

The following information discusses the basic factors to consider when choosing slide products. Should you need a recommendation or have further questions, please contact us at archinfo@accuride.com or 888-459-8624.

DESIGN FACTORS

As with the selection of any system component, when choosing a slide for a specific application, you should consider the full range of features by comparing the project requirements to the key performance elements of the slide.

LENGTH

Slide length is measured as the longest dimension of a fully closed slide. As a rule, always specify the maximum length allowable in the application.

EXTENSION

Or “travel”, refers to how far the drawer extends from the cabinet.

- 3/4 extension** Drawer opens partially, about 3/4 of the total slide length.
- Full extension** Drawer opens the same amount as the slide length.
- Over travel** Drawer opens more than the length of the slide.

DRAWER WIDTH

In general, wider drawers require a slide with a higher load rating and a cross section designed to withstand lateral stress. Each slide has a specified maximum drawer width to ensure optimum performance.



Furniture by www.diamondcase.com

DISCONNECTS

The disconnect feature enables you to remove a drawer or drawer member for mounting or general purposes.

- Lever** Disconnect is achieved by releasing an internal lever and pulling the drawer straight outward, away from the cabinet.
- Rail** A rail latch allows you to lift the drawer off the slide and away from the cabinet. This type of disconnect facilitates smooth movement and easy drawer removal.
- Friction** Disconnect is achieved by pulling the drawer firmly through the resistance of the ball retainer.
- Push Latch** A latch is pressed to release the drawer, which is pulled firmly through the resistance of the ball retainer.

SLIDE PROFILES

More than one slide profile (or height) may be appropriate for a given application. Accuride provides several low-profile design options for applications in which a smaller profile would enhance the appearance of the completed unit.

LOAD FACTORS

Most Accuride slides are tested a minimum of 50,000 cycles in accordance with the guidelines of all applicable ANSI/BIFMA specifications or as appropriate for moderate use applications. See the product technical sheet for specific information regarding test criteria. Thorough testing means you can rely on Accuride products to meet industry accepted criteria.

Our slides are rated for the dynamic load that an 18" pair will carry without failure (load rating decreases proportionally beyond the 18" length). In all cases, the static (resting) load capacity of each model is at least twice the load rating, providing at minimum a 100% static safety factor, even when the slide is loaded to its maximum rating. Because slide performance may be affected by factors unique to a specific application, always test slides in the intended application.

SLIDE SELECTION CRITERIA

ENVIRONMENTAL FACTORS

Unless otherwise stated, Accuride slides are designed for indoor use and should be protected from excessive moisture, chemical fumes, dirt, and corrosion. The Accuride self-cleaning ball retainer protects slide raceways by removing foreign particles between ball bearings, and the lubricant provided is sufficient for normal slide life.

Commercial drawer slides are designed to be used for extended periods in temperatures between 0 and 180 degrees Fahrenheit. Extreme temperatures can negatively affect the lubricant and plastic or rubber components. For information regarding use outside normal temperature and humidity ranges, contact the Architectural Support Line.



FINISHES & MATERIALS

Below is an overview of slide finishes and materials. Although not represented in this catalog, Accuride offers a selection of stainless steel and aluminum products designed to resist moisture and corrosion. For more information, visit our web site or call our Architectural Support Line.

STEEL SLIDES:

Slide members and ball retainers are made from cold-rolled steel; ball bearings are carburized steel.

STANDARD FINISH (C):

Clear zinc electroplate

OPTIONAL FINISHES:

CB - Black electroplate

EW - White electrocoat

CH - Weather resistant

STAINLESS STEEL:

Slide members, ball retainers, and ball bearings are stainless steel.

ALUMINUM:

Slide members are aluminum, ball retainers and bearings are stainless steel.

SPECIAL FEATURES

There are a number of special features available designed to enhance applications. Be sure to fully explore these options to determine the best solution for your project. Some of the more popular features include:

SOFT OR EASY-CLOSE (EC)

This feature brings drawers to a gentle close, providing smooth and quiet operation.

SELF-CLOSING (SC)

Brings drawers to a close and keeps them closed for a neat and tidy environment.

TOUCH RELEASE (TR)

This option holds drawers in a closed position until the drawer front is pressed inward to release the latch. This offers knob-less and in some instances, hands-free access to drawers or shelves.

DETENTS AND LOCKS

While most Accuride slides offer a hold-in detent to prevent drawers from rolling open, some also offer a hold-out detent, which allows drawers or shelves to remain in an extended position with some degree of stability. Selected products are available that offer a locking option for a durable position hold that benefits mobile applications.



Furniture by www.diamondcase.com

TECHNICAL SUPPORT

Please visit the Technical Resources section on our web site at www accuride.com for the most current technical information. For questions regarding specifications, or slide applications, contact our Architectural Coordinator by e-mail at archinfo@accuride.com or call 888-459-8624.

SPECS AT A GLANCE

LIGHT-DUTY SLIDE

MODEL	LOAD RATING	TRAVEL	DRAWER WIDTH	DETENT	DISCONNECT	PAGE
2632	65 lbs. [30 kg]	Full	16" [406 mm]	Hold-in	Rail	6

MEDIUM-DUTY SLIDES

MODEL	LOAD RATING	TRAVEL	DRAWER WIDTH	DETENT	DISCONNECT	PAGE
3832	100 lbs. [45 kg]	Full	16" [406 mm]	Hold-in	Lever	7
3834	90 lbs. [41 kg]	1" Over [25.4 mm]	16" [406 mm]	Hold-in	Lever	7
3132EC	100 lbs. [45 kg]	Full	30" [762 mm]	Hold-in	Lever	8
7432	100 lbs. [45 kg]	Full	24" [610 mm]	Hold-in	Rail	8
7434	100 lbs. [45 kg]	1" Over [25.4 mm]	24" [610 mm]	Hold-in	Rail	8

HEAVY-DUTY SLIDES

MODEL	LOAD RATING	TRAVEL	DRAWER WIDTH	DETENT	DISCONNECT	PAGE
4032	150 lbs. [68 kg]	Full	27" [686 mm]	Hold-in	Rail	9
4033	100 lbs. [45 kg]	Full	18" [457 mm]	Hold-in	Rail	9
4034	150 lbs. [68 kg]	1.5" Over [38.1 mm]	24" [610 mm]	Hold-in	Rail	9
4035	100 lbs. [45 kg]	1.5" Over [38.1 mm]	18" [457 mm]	Hold-in	Rail	9
3641	180 lbs. [82 kg]	1" Over [25.4 mm]	42" [1067 mm]	Hold-in	Rail	10
3640A	200 lbs. [91 kg] Side mount 75 lbs. [34 kg] Flat mount	1" Over [25.4 mm]	42" [1067 mm] 24" [610 mm]	Hold-in	Rail None	10
7950	350 lbs. [159 kg]	Full	42" [1067 mm]	Hold-in	None	11
7957	350 lbs. [159 kg]	Full	42" [1067 mm]	Hold-in	Lever	11
9301	500 lbs. [227 kg] Moderate use 400 lbs. [181 kg] Frequent use 300 lbs. [136 kg] Mobile/Vehicular 150 lbs. [68 kg] Flat mount 500 lbs. [227 kg] Bracket mount 350 lbs. [159 kg] Bracket mount	Full	18" [457 mm] 42" [1067 mm] 32" [813 mm] 32" [813 mm] 18" [457 mm] Up to 42" [1067 mm]		None	11

SPECS AT A GLANCE

MEDIA ACCESS PRODUCTS

MODEL	LOAD RATING	MAXIMUM SIZE	APPLICATION BENEFITS	PAGE
CBLift-0019 Ascent	14.5 lbs. [6.6 kg]	N/A	Push-to-operate mechanical lift for screens up to 17.5" tall and 22" diagonal.	12
CBMAC-50 Media Access	150 lbs. [68 kg]	Shelving Units 20-3/4" wide x 18" deep up to 36" tall	The M.A.C. provides easy access to A/V component wiring in security and electronic control centers, sound systems, lecterns, etc. Model CBmac-50, designed for lighter duty applications, includes one swivel assembly.	13
CBMAC-100 Media Access	300 lbs. [136 kg] Center	Shelving Units 20-3/4" wide x 18" deep up to 55" tall	Model CBmac100 accommodates taller and heavier shelving units for larger, more complex installations. This system includes two swivel assemblies.	13

FLIPPER DOOR SLIDES®

MODEL	MAXIMUM DOOR WEIGHT	MOUNTING	MAXIMUM DOOR SIZE	PAGE
1155 Easy-Down®	30 lbs. [14 kg]	Horizontal	Up to 48" wide [1219 mm]	14
1321 Pro Pocket	30 lbs. [14 kg]	Vertical	24"w x 42"h [610 mm x 1067 mm]	14
1332/1432 Anti-Rak Cable	75 lbs. [34 kg]	Vertical	26"w x 78"h [660 mm x 1981 mm]	15

SPECIALTY PRODUCTS

MODEL	LOAD RATING	TRAVEL	DRAWER WIDTH	DETENT	DISCONNECT	PAGE
2006 Pencil drawer slide	45 lbs. [20 kg]	3/4	16" [406 mm]	None	Friction	16
2109 Suspended drawer slide	75 lbs. [34 kg]	3/4	16" [406 mm]	Hold-in and -out	Lever	16
0363 Two-way travel slide	100 lbs. [45 kg]	Full	18" [457 mm]	Center	None	17
301-2590 Pull-out storage slide	155 lbs. [70 kg]	.83" Over [21 mm]	16" [406 mm]	Hold-in	None	18
3600-200/3600-201 StowAway slides	175 lbs. [79 kg]	Full	16" [406 mm]	None	Lever	18



Need something you don't see here?

This catalog reflects only a sampling of the Accuride product line. For a complete listing of our products, visit www.accuride.com. If you have a question regarding a specific product need, please call our Architectural Support Line at 888-459-8624.

2632

65-LB. LOAD RATING



APPLICATIONS:

Suitable for light-duty commercial or residential use, store fixtures, lab furniture, or kitchen box drawers. The rail mounting style of this slide ensures smooth and quiet operation.

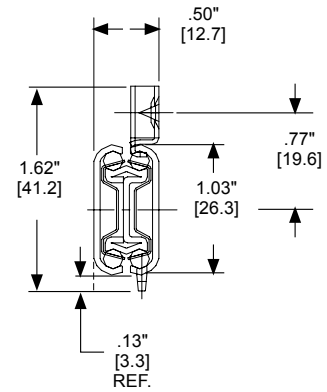

SPECIFICATIONS

- Full extension
- .50" side space
- Drawers up to 16" wide
- Rail mount/disconnect
- Even lengths 8"-22"
- Clear zinc or black finish

SPECIAL FEATURES

- Lowest profile rail mount
- Hold-in detent to prevent drawer roll-out and bounce-back
- Silenced in and out

3832 Family

90-100-LB. LOAD RATING

APPLICATIONS:

This versatile group of products offers a number of options adaptable nearly any environment whether residential, commercial, retail, or institutional.

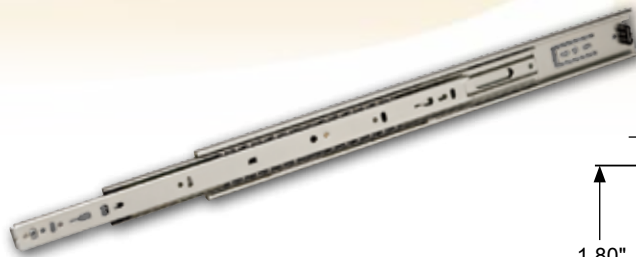

BHMA
CERTIFIED

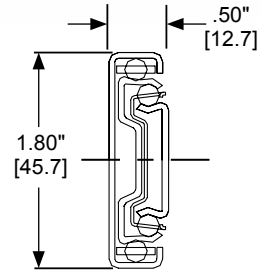

SPECIFICATIONS

- Full extension
- .50" side space
- Drawers up to 16" wide
- Lever disconnect
- Clear zinc, black, or white finish**

SPECIAL FEATURES

- Hold-in detent to prevent drawer roll-out and bounce-back
- Silenced in and out
- Models 3832, 3834, 3832SC, 3834SC, 3832DO, and CH3832 are BHMA certified to Grade 1 HD-100 standard

3832-CLASSIC

- Even lengths 6"-28"

3834-OVER TRAVEL

- 1" over travel provides complete access to drawer contents
- 90-lb. load rating
- Even lengths 12"-28"

** Finish options vary by model

3832EC-EASY-CLOSE

- Brings drawers to a gentle close. This popular soft-close feature adds value to most application environments.
- Even lengths 14"-28"
- Not available in white finish

3832SC-SELF-CLOSING

- Unique self-closing device pulls drawers to a close. A good choice for store fixtures, where closure assures a neat and safe environment.
- Even lengths 12"-26"

3834SC-SELF-CLOSING

- 90-lb. load rating
- Self-closing pulls drawers to a close
- 1" over travel provides full access to drawer contents.
- Even lengths 14"-26"

3832HDSC-HEAVY-DUTY SELF-CLOSING

- This product's self-closing device has a heavier spring for a stronger closing/stay-closed action. Especially useful in mobile applications.
- Even lengths 12"-28"

3832DO-DETENT OUT

- Detent out holds drawers or pull-out shelves in an open position. Good for work surface applications.
- Even lengths 10"-28"

3832TR-TOUCH RELEASE

3832HDTR-HEAVY-DUTY TOUCH RELEASE

- These products hold drawers or roll-out shelves in a closed position until activated by touch.
- Eliminates the need for knobs or pulls.
- Standard model is ADA compliant.
- Heavy-duty model works well in mobile applications.
- Even lengths 12"-28"

CH3832-WEATHER RESISTANT

- Special coating provides eight times more protection than the standard zinc finish.
- Ideal for applications subjected to indirect humidity.
- Even lengths 10"-28"

3132 Eclipse

100-LB. LOAD RATING



APPLICATIONS:

Featuring the popular Easy-Close action, the Eclipse undermount offers a fully concealed slide solution designed to meet the demands of commercial and residential installations.



SPECIFICATIONS

- Full extension
- Accommodates drawers up to 30" wide
- Front lever disconnect
- BHMA certified to Grade 1 HD-100 standard
- Even lengths 12"–28", plus 15" and 21"; 10" available for 3132EC only
- Clear zinc finish

SPECIAL FEATURES

- Easy-Close brings drawers to a smooth and quiet close.

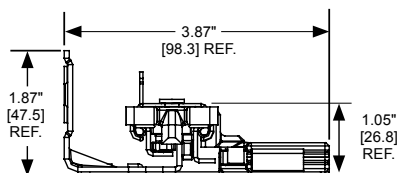

7432/7434

100-LB. LOAD RATING



APPLICATIONS:

This is the top quality choice for file, desk, and storage drawers in commercial or residential applications. The rail mounting style and progressive movement provide exceptionally smooth movement.



SPECIFICATIONS

- .50" side space
- Drawers up to 24" wide
- Note: These products have also been tested for use in drawers up to 33.5" wide (width of a standard 3-ft. case section).
- Rail mount/disconnect
- BHMA certified to Grade 1 HD-100 standard
- Even lengths 12"–28"
- Clear zinc or black finish

SPECIAL FEATURES

- Premium progressive movement
- Hold-in detent to prevent drawer roll-out and bounce-back

7432

- Full extension

7434

- 1" over travel

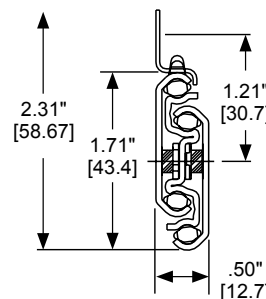

400 Series

100–150-LB. LOAD RATING

APPLICATIONS:

Providing smooth and quiet operation for larger, deep drawers, the 400 series slides are true workhorses for demanding applications in business and home office, medical facilities, or retail storage and display installations.

Furniture by www.diamondcase.com

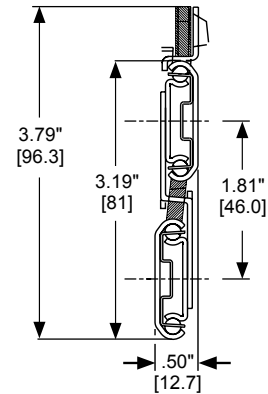
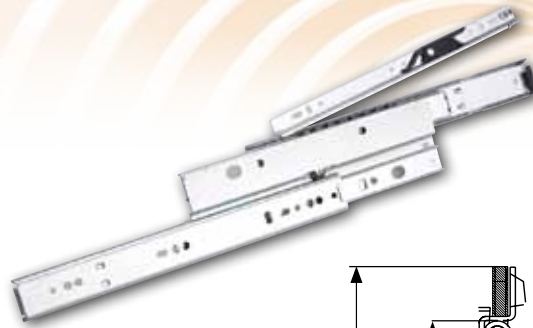

4032—For wider drawers

- Drawer widths up to 27"
- 150-lb. load rating
- Full extension

4033—Extra quiet operation

- Drawer widths up to 18"
- 100-lb. load rating
- Full extension
- Not recommended for lateral files

4034—Over travel with a higher load

- Drawer widths up to 24"
- 150-lb. load rating
- 1.5" over travel

4035—Over travel

- Drawer widths up to 18"
- 100-lb. load rating
- 1.5" over travel
- Not recommended for lateral files

SPECIFICATIONS

- .50" side space
- Rail mount/disconnect
- Even lengths 12"–28"
- Clear zinc or black finish

SPECIAL FEATURES

- Progressive movement
- Hold-in detent to prevent drawer roll-out and bounce-back
- Silenced in and out

3641

180-LB. LOAD RATING

APPLICATIONS:

Suitable for commercial or residential filing cabinets or other wide drawers where an interlock feature would add a measure of safety to prevent more than one drawer from opening at a time.



SPECIFICATIONS

- 1" over travel
- .89" side space
- Drawers up to 42" wide
- One piece rail-and-pocket mount/disconnect system
- Even lengths 14"-28" and 17"
- Clear zinc or black finish

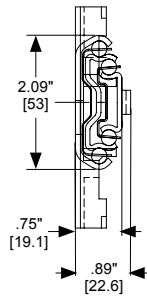

SPECIAL FEATURES

- Interlock feature prevents more than one drawer from opening at a time. This feature helps prevent tipping of heavy, multi-drawer units.
- Interfaces with a central locking system
- Hold-in detent to prevent drawer roll-out and bounce-back
- Silenced in and out

3640A

200-LB. LOAD RATING



APPLICATIONS:

May be side or flat mounted. Recommended for wide drawers found in office settings, commercial store fixtures, or residential settings.



SPECIFICATIONS

- 1" over travel
- .89" side space
- Adapter rail mount and disconnect
- Even lengths 12"-28"
- Clear zinc or black finish

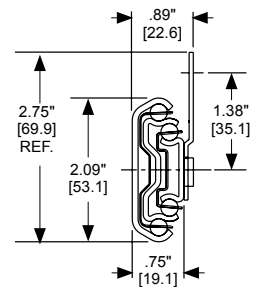

SPECIAL FEATURES

- BHMA certified to Grade 1 HD-100 standard
- Dual mounting options:
 - 200 lb. side mount
 - drawer widths up to 42"
 - 75 lb. under/flat mount
 - drawer widths up to 24"
- Hold-in detent to prevent drawer roll-out and bounce-back

7950 & 7957

350-LB. LOAD RATING

APPLICATIONS:

These products are a good intermediate load-rating choice for wider drawers in kitchens, store fixtures, or institutional storage applications.



SPECIFICATIONS

- Full extension
- .75" side space
- Accommodates drawers up to 42" wide
- Even lengths 12"–36"
- Clear zinc finish

SPECIAL FEATURES

- May be side or flat mounted:
 - Side mount load capacity up to 350 lbs.
 - Flat mount load capacity up to 150 lbs.
- Bridged ball retainer design prevents retainer migration.

7950

NON-DISCONNECT

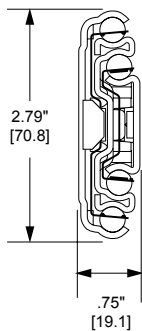

7957

HANDED LEVER DISCONNECT

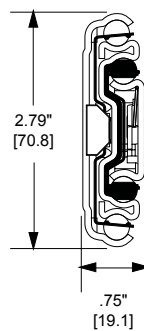

9301

150–500-LB. LOAD RATING

APPLICATIONS:

Well suited for large pantry pull-outs, heavy-duty storage, or other applications where a heavier load must be managed.

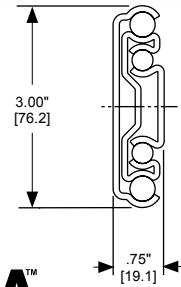

BHMA
CERTIFIED



SPECIFICATIONS

- Full extension
- .75" side space
- Non-disconnect
- BHMA certified to Grade 1 HD-200 Standard
- Silenced in and out
- Even lengths 10"–36", 40", 42", 44", 48", and 60"
- Clear zinc finish

SPECIAL FEATURES

- Accessory platform bracket kits provide six additional mounting configurations See product technical sheet for additional information

NOTE: Load ratings vary depending on application. Please see the technical sheet for basic load rating guidelines. For further assistance, contact the Architectural Support Line at 888-459-8624.

Caution: This slide must never be used as a pull-out step, platform or any other application supporting human weight, as injury may result.

Ascent – CBLift-0019

14.5-LB. LOAD RATING

APPLICATIONS:

The Ascent is a compact push-to-operate mechanical lift that provides access and conceals small screens in desks and other cabinetry in classrooms, reception counters, conference rooms, service desks, offices, and more.

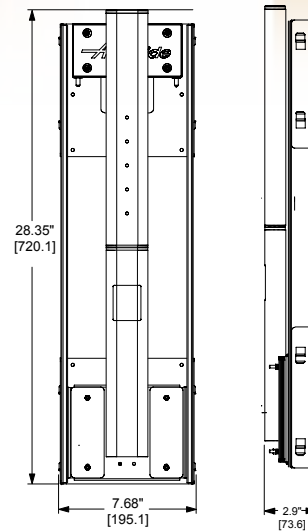

Perfect for spaces that serve multiple uses or where desktop space is limited.



SPECIFICATIONS

- Accommodates screens from 5.5–14.5 pounds, up to 17.5" tall, and 22" diagonally.
- No power required; movement is controlled by counterbalancing weights.
- Swivels $\pm 112.5^\circ$ for expanded viewing access
- Black electroplate finish

SPECIAL FEATURES

- Easy to install
- Unit raises 21 inches in less than 2 seconds.

OPTIONAL KITS

- Packaging includes wire management, cable control kit, and one weight pack. Additional weight pack kits are available for order.
- Does not include bracket to mount the screen to the Ascent. Fixed or adjustable VESA Bracket Kits are available for order.
- Please see the product technical sheet for more information.

M.A.C.s – Media Access Centers

150–300-LB. LOAD RATING

APPLICATIONS:

The M.A.C. gives end-users full access (front and back) to media components in cabinetry. In addition to residential entertainment applications, this product is appropriate for security and electronic control centers, sound system components, lecterns, and other audio/visual set ups.



Accuride's Media Access Centers provide an aesthetic method to integrate components into cabinetry.



CBMAC 100

SPECIFICATIONS

- Accommodates shelving units 20-3/4" wide by 18" deep
- Full 20" extension
- Slides black electroplate; swivel plate black powdercoat
- Compatible with EIA mounting standards

SPECIAL FEATURES

- 90° rotation in both directions provides full access to the back of shelving units.
- Rotation function actuates only when slides are fully extended preventing damage to the inside of the cabinet.
- Detent-in and detent-out holds shelving units securely in place.
- Cable management helps keep wires clear of the slides.
- Cable clips attach to shelves to keep wires neatly bundled at the back of components.
- Power strip and cable ties included

CBMAC-100

- 300-lb. load rating*
- Includes top and bottom swivel assemblies
- Accommodates shelving units up to 55" tall

CBMAC-50

- 150-lb. load rating*
- Includes one swivel assembly
- Accommodates shelving units up to 36" tall

* Load ratings based on 10,000 cycle test

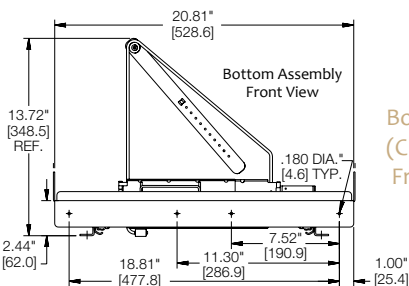
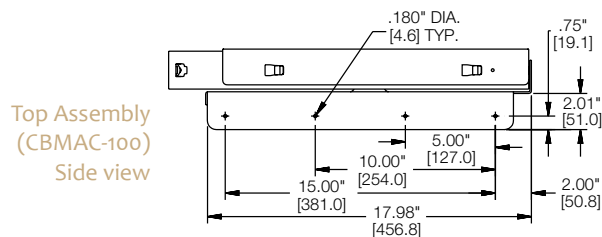

Bottom Assembly
(CBMAC-100 & CBMAC-50)
Front view

1155 Easy-Down®

30-LB. LOAD RATING

APPLICATIONS:

The Easy-Down® has a motion control system to ensure overhead doors close safely. It's great for overhead storage in kitchens, hobby or bedrooms, and business or home office environments.



SPECIFICATIONS

- Accommodates door widths up to 48"
- Even lengths 12"–24"
- Clear zinc or black finish

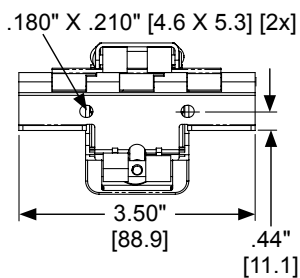

SPECIAL FEATURES

- Over-the-top design provides no loss of normal storage space
- Protects user from rapid drop of door
- Door closing speed remains similar on both light and heavy doors.
- Cylinder cover cap provides a finished look (not shown)

The cylinder for the Easy-Down® is covered by a five year limited warranty.

1321 Pro Pocket

30-LB. LOAD RATING

APPLICATIONS:

The Pro Pocket is a full 3/4-inch overlay Flipper Door Slide® with special features that virtually eliminate door damage. Designed for smaller retracting doors in entertainment centers, armoires, conference rooms, or retail displays.

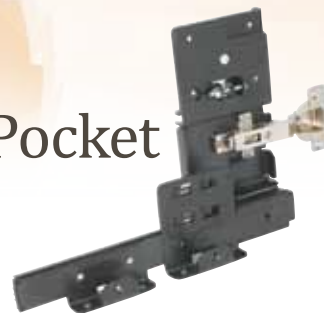

SPECIFICATIONS

- Doors up to 42" tall by 24" wide
- Even lengths 16"–28"
- Black electroplate finish

SPECIAL FEATURES

- Auto-open feature pushes cabinet doors open the last 1-1/4" of travel to ensure doors are fully extended.
- Skid blocks with indexing marks ease installation, and protect door face, top, and bottom.
- Cover caps provide aesthetic finish

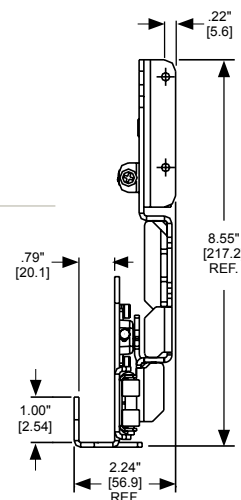

1332/1432 Cable System

75-LB. LOAD RATING

APPLICATIONS:

Designed for taller, heavier doors such as those found on armoires, installed in dressing rooms and walk-in closets, or cabinetry designed for audio/visual components in conference rooms or home entertainment centers.

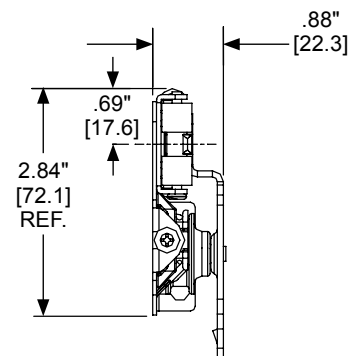
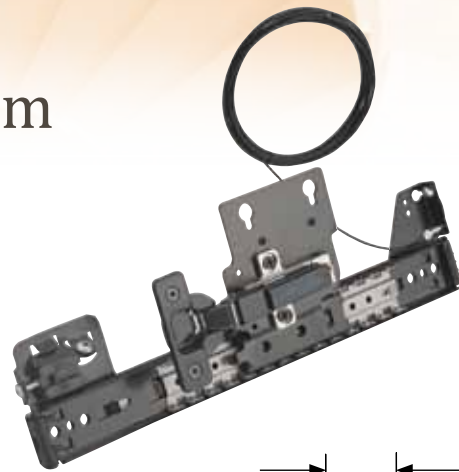

SPECIFICATIONS

- Door heights up to 78"
- Door widths to 26"
- Doors 36"–78" tall require additional hinges. See technical sheet for further details.
- Lengths 12"–32"
- Hold-out detent
- Silenced in and out
- Standard black or optional clear zinc finish

1332—35 mm inset hinges included

1432—Hinges purchased separately

2006



45-LB. LOAD RATING

APPLICATIONS:

Known as the pencil drawer slide, this product is designed for suspended drawers or shelves beneath desks or tabletops.

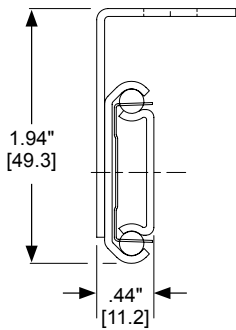

SPECIFICATIONS

- 3/4 extension
- .44" side space
- Drawer widths up to 16"
- Friction disconnect
- Simple, fixed height bracket installation
- Lengths 12"-28"
- Clear zinc or black finish

2109



75-LB. LOAD RATING

APPLICATIONS:

This slide offers height adjustment and a higher load rating. Intended for suspended shelves or trays in applications such as workstations, reception counters, and security stations, the detent features help pull-outs in the desired position.

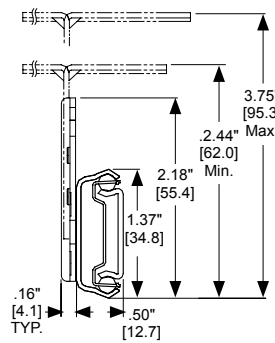

Bracket mounts
inboard or
outboard

SPECIFICATIONS

- 3/4 extension
- .50" side space (.66" with bracket)
- Drawer widths up to 16"
- Lever disconnect
- Even lengths 12"-28"
- Clear zinc or black finish

SPECIAL FEATURES

- Hold-in and hold-out detent
- Variable height mounting brackets
- Flexibility of inboard or outboard bracket mounting

0363 Two-Way Travel

100-LB. LOAD RATING

APPLICATIONS:

Offering full extension and two-way travel, this slide is for use in kitchen islands, commercial kitchens, dining or entertainment bars, or other cabinetry or carts that benefit from two-sided access.

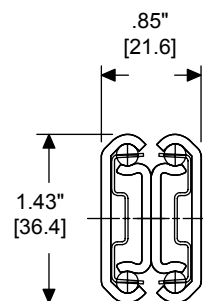

SPECIFICATIONS

- Full extension from center point in both directions
- .85" side space
- Drawers up to 18" wide
- Non-disconnect
- Tested to 80,000 cycles
- Available lengths: 16", 20", 24", and 28"
- Clear zinc finish

SPECIAL FEATURES

- Two-way travel provides access from both sides of installations.
- Hold-in detent at center keeps conveyances in a stable, centered position until use.

301-2590

155-LB. LOAD RATING

APPLICATIONS:

Shelf or platform mounted pull-outs for kitchen pantries or entertainment centers; medical or institutional carts and storage.

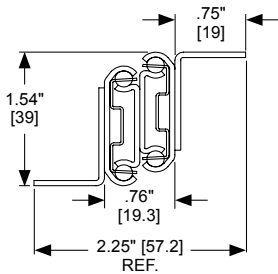

SPECIFICATIONS

- .83" over travel
- 1.54" vertical space
- Drawers up to 16" wide
- Non-disconnect
- Even lengths 12"-28"
- Clear zinc or black finish

SPECIAL FEATURES

- Mounts under shelves
- Hold-in detent to prevent drawer roll-out and bounce-back

3600-200/3600-201

StowAway Slides

175-LB. LOAD RATING

APPLICATIONS:

Keep waste containers, recycle, and utility bins in kitchens, laundry or hobby rooms neatly out of sight. These slides include a self-closing feature, which ensures pull-outs come to complete closure.



SPECIFICATIONS

- Full extension
- Drawers up to 16" wide
- Standard 22" length
- Clear zinc finish

SPECIAL FEATURES

- Self-closing action begins 2-1/2" from cabinet opening
- Handed lever disconnect
- Attached brackets permit side, top or bottom mounting

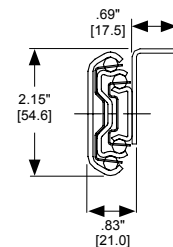

3600-200

- One fixed inboard bracket
- Outer member side mounts directly to cabinet wall

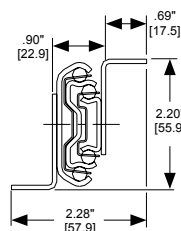

3600-201

- Inboard top bracket and outboard bottom bracket
- Slide may be mounted to the top or bottom of the cabinet

Limited Lifetime Warranty

Accuride International Inc. warrants its Accuride-branded drawer slides against defects in material and workmanship for so long as the original purchaser owns them.* This warranty does not cover drawer slides which have been damaged due to abuse, improper installation, excessive loads, or any use contrary to the instructions accompanying the product. Accuride will send the original purchaser a replacement of the same model or a comparable model at no cost. This warranty is for replacement only and does not cover the cost of removal, installation, or incidental charges.

To obtain a replacement slide under this warranty, contact Accuride Technical Support within 30 days of the discovery of the defect. Please let us know how the product was used and the type of defect or malfunction experienced. Contact us by e-mail or phone at:

Technical@accuride.com
or 562-903-0200, ext. 1436**

The foregoing express limited warranty is in lieu of all other express warranties and excludes incidental or consequential damages. This warranty does not apply to products sold and used outside of the United States and Canada. All warranties implied by state law, including implied warranties of merchantability and fitness for a particular purpose, are expressly limited. Some states do not allow limitations on how long an implied warranty lasts or exclusion of incidental or consequential damages, so the foregoing limitation or exclusion may not apply to you. This Limited Lifetime Warranty gives you specific legal rights, and you may have other rights which vary from state to state.

* This warranty does not apply to the cylinder for the Easy-Down® Flipper Door Slide®, CBERGO-TRAY Keyboard Systems, or any other Accuride product for which the expressed warranty differs from the Limited Lifetime Warranty offered above. Call Accuride Technical Support for further information.

** NOTE: For general questions or assistance unrelated to product warranty, please call the Architectural Support Line at 888-459-8624 or e-mail us at archinfo@accuride.com.

Notes:



Lunchtime Learning

Munch A Free Lunch and Learn about Sliding Hardware

If you would like to learn about sliding hardware and the basic criteria important to proper slide selection, then our Lunchtime Learning Program is for you. An Accuride representative will come to your location, provide lunch, and an informative one-hour educational program.

WHO'S WELCOME?

Architects, specifiers, designers, owners, and other design professionals of all levels of experience. Whether you are new to sliding hardware or a seasoned veteran, we guarantee you'll learn something.

WHAT CAN YOU LEARN?

The Proper Use, Design, and Specifications of Quality Cabinet Hardware

We'll explain the differences between the types of slides and the basic factors that should be considered when deciding on which slide model is best for your application. We'll also discuss the special features available that can enhance specific applications.

HOW MANY CAN ATTEND?

There's no limit. We can accommodate an audience as large as your location permits.

WHAT DO WE NEED?

Presenters require only electric power and a screen for their presentation.

WHO ARE THE INSTRUCTORS?

Accuride's knowledgeable staff is committed to providing technical assistance and education to design professionals. We will help you make the right slide choice to ensure long-lasting and reliable performance—and help you take your projects from basic to beyond.

CALL TODAY TO SCHEDULE:

888-459-8624

Accuride®

Always Moving Forward

ACCURIDE INTERNATIONAL INC.

NORTH AMERICA

INTERNATIONAL HEADQUARTERS
12311 Shoemaker Avenue
Santa Fe Springs, California 90670
562 903-0200 Telephone
562 903-0208 Fax
www accuride.com

Calle Circuito Norte No. 6
Parque Industrial Nelson
Mexicali, B.C., C.P. 21395 Mexico

EUROPE

Postfach 1464
Werner - Von Siemens - Strasse 16-18
65582 Diez/Lahn
Germany
(49 64 32) 6 08-0 Telephone
(49 64 32) 6 08-20 Fax
www accuride-europe.com

Liliput Road
Brackmills Industrial Estate
Northampton, NN4 7AS
United Kingdom
(441) 604-761111 Telephone
(441) 604-767190 Fax
www accuride-europe.com

ASIA

Accuride Japan Co., Ltd.
44 Minami-asaji Iwata Yawata-shi
Kyoto, Japan
81-75-983-7500 Telephone
81-75-983-9500 Fax
www accuride.co.jp

Accuride International Suzhou Co. LTD
No. 178, Suhong East Road
Suzhou Industrial Park
Jiangsu Province, China 215026
86-512-62731200 Telephone
86-512-62833993 Fax
www accuride.com.cn

Follow us



Facebook: <http://bit.ly/accuridearch>
Twitter: <http://twitter.com/accuridearch>

