

In this Issue...

An ADA Compliant Solution

Squeezing More Out of Your Space

News Bites

An Over-the-Top Option

Meet Your Market Champion

Break Out!

Hungry for Learning?

The Real Steel Deal

Break Out!

Most people drive to work the same way every day. After a while, the passing scenery becomes familiar and they begin to operate on autopilot. The journey becomes so much a part of the daily routine that most people don't even think about altering their route unless forced to by some reason.

On the other hand, what if you altered your route intentionally—just because? You might discover the most amazing bagel shop, gas for 10 cents less a gallon, or maybe even the love of your life. Who knows what life-changing event might occur?

Let's apply that idea to what you do every day. What if you changed just one thing to break out of an established pattern? Simply alter one choice you've adopted because it's easy, predictable—or safe. You might discover something new or solve a problem you've been working around or struggling with for years. Maybe that change is trying a new supplier, taking a new approach, or substituting a component or material in a project.

How does this apply to slides? Although many designers may rely on the same two or three basic slides for their projects, Accuride has one of the most extensive lines of slide products in the industry. As a result, there are probably dozens of slides you have never heard of—let alone considered as a potential solution for a design. Imagine what you might be missing.

Be sure you take advantage of the resources available to you: our Marketing Architectural Coordinator and your local District Sales managers. They can help you navigate the solutions available to you that could take your designs to a new level. Ready to break out of that routine? Contact us by e-mail at archinfo@accuride.com or call 888-459-8624.



Designs IN MOTION

A New Addition

You may have noticed we are sporting a new tagline: Always Moving Forward. What is this all about?

For Accuride, continual improvement is an unending journey; we're always on the look out for ways to enhance our products and services.

Whether it's field support, engineering, or accounting, our entire team works closely with our customers to provide exceptional support and technical advice—to guide them to smart solutions that move their markets forward.

Always exploring, always designing, always refining.

Accuride—always moving forward.

Accuride[®]
Always Moving Forward



Meet Your Market Champion

Now you can put a face to the name and voice: presenting Accuride's Marketing Architectural Coordinator, Christina Alfaro.

Joining Accuride more than 6 years ago, Christina started out as a Marketing Assistant managing the design and update of our product technical sheets and promotional item program. Promoted to her current position about 18 months ago, she has embraced her duties with enthusiasm and creativity, while concurrently earning her Associate of Science degree in Web Design and Development.

Christina answers the Architectural Support Line, providing technical support, product selection, and specification advice. She keeps her finger on the pulse of the industry, while managing the development of market-specific communications and the Lunchtime Learning program.

She is active with the local Los Angeles CSI chapter, where she volunteers her skills to create event and e-mail communications for the group. She is currently studying for her CDT certification.

In her free time (what little there is), she enjoys bike riding, spending time with her husband Joe and their dog Dehlilah, and chasing food trucks throughout L.A.

If you have any suggestions or questions, or would just like to say "hi", give Christina a call on the Architectural Support Line or drop her an e-mail at archinfo@accuride.com. If you attend AIA this coming May, you'll see her smiling face at booth #4325.



Hungry for Learning?

We've combined two of our favorite things—slides and sandwiches—to bring you an educational and epicurean experience that is sure to entertain. If you would like to learn more about sliding hardware and the basic criteria important to proper slide selection, then our Lunchtime Learning Program is for you.

How Does It Work?

We will come to your location, provide lunch, and present a useful one-hour program.

Who Should Attend?

Everyone is welcome—architects, specifiers, designers, owners, purchasing staff, or others who might benefit from this program. Whether you are new to sliding hardware or a seasoned veteran, we guarantee you'll learn something.

What is the Program About?

The main topics include slide components and how they work, important factors to consider when selecting slides, and special features that add value to projects.

Learning Unit Credit

Although we currently do not offer LU credits for this course, by late spring, the course will be AIA approved and will provide you with one LU credit. We will be authorized providers in two regions: **Atlantic** (New

Jersey, New York and Pennsylvania) and **Pacific Southwest** (Arizona, California, Colorado, Nevada, New Mexico and Utah)

Whether you take the course for credit or simply as a learning experience, we believe this information will arm you to boldly navigate the world of sliding hardware.

How Many Can Attend?

There's no limit. We can accommodate an audience as large as your location comfortably permits.

What Do We Need?

Presenters require only electric power and a screen for their presentation.

Who Is The Instructor?

Accuride's Marketing Architectural Coordinator, Christina Alfaro, who oversees communications and educational resources for the Architectural market. She will make the presentation, answer technical or sourcing questions, and assist you with product selection and specification challenges.

This free program will help your team make informed slide choices that will provide long-lasting and reliable performance—and take your projects from basic to beyond. Call today to schedule: 888-459-8624.



New Tools for You

Be sure you check out our new catalog especially designed for the architectural and design market. It's a slimmed down version of our regular catalog comprised of a core group of products intended to simplify the selection process. You may order a catalog (or an entire binder of helpful information) online at <http://bit.ly/LitRequest>.

a green product solution

Just think of the space you could save in classrooms and conference centers where desktop space is at a premium.



The Ascent does not require power to operate, it uses the basic, clean principle of spring tensioning and counterbalancing to operate.

Squeezing More Out of Your Space

As you may know too well, many people are making the most of what they have these days—especially space. It seems we're all making our space work harder; using it for multiple purposes, and in some cases, reducing the amount of space due to economics.

We see examples of this with businesses moving into smaller workspaces or sharing facilities with other merchants. With the closure of schools and medical offices, the number of people using the facilities that remain has increased. In terms of residential changes, multiple generations are sharing one home, while other families are downsizing into smaller residences.

...people are making the most of what they have these days—especially space.

In light of this trend, we have a product that helps spaces multitask—the Ascent—Accuride's mechanical lift designed for small screens. It provides the means to free up desk space by concealing screens within cabinetry when not in use.

The Ascent has a slim and compact design that requires a small envelope of space. This makes it a good fit when adding computer or TV screens into desks for kids rooms, home office set ups, or even a corner of the kitchen. Whether it is a workstation for household projects, homework, web surfing, or to watch



movies, the Ascent helps bring efficient multi-tasking to many areas of the home.

In commercial and institutional environments, the Ascent carries touch screens or monitors for video surveillance, or as a means to deliver training or status information at customer service kiosks or counters. Classrooms, hospital reception counters, nursing stations, and business offices or conference rooms are other busy environments that benefit by the ability to conceal screens when activities are complete.

If we were to sum up this product in a word, it would be **simplicity**. It is simple to operate and it operates simply; the Ascent does not require electrical power, making it a greener lift choice.

How does it work?

The Ascent's movement is based on spring tensioning that is counterbalanced with weights. This creates smooth, controlled, and customizable movement. To raise screens, a light push on the top of the unit activates the lift. This releases a latch, allowing the unit to rise to a fully extended position in about 2 seconds. To conceal screens, the top of the lift column is pushed to lower the unit into the cabinet until it latches in to the closed position.

If this versatile product sounds like it might solve a design challenge for you, there are detailed specifications and CAD drawings available on our web site. Just type "Ascent" in the Search box to get a link to the product information. You will also find an animation of this product on our web site at the bottom of this page under Videos/ Animations/: <http://bit.ly/TechResource>.

For additional questions regarding product specifications or applications, or to schedule a demonstration of this product, contact our Marketing Architectural Coordinator by e-mail at archinfo@accuride.com or call 888-459-8624.

ASCENT MECHANICAL LIFT CBLIFT-0019

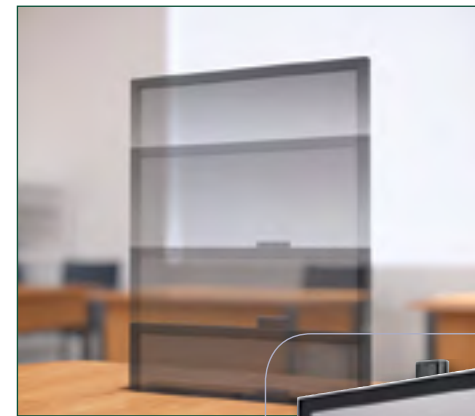

Specs at a Glance

- Holds screens from 5.5 to 14.5 pounds, up to 17.5 inches tall and 22 inches diagonally.
- Unit raises 21 inches in less than 2 seconds
- Swivels ± 112.5° for expanded viewing access
- Black electroplate finish
- RoHS Compliant
- Packaging includes wire management, cable control kit, and one weight pack (additional weight packs may be purchased separately).



Optional 18° tilt or fixed VESA bracket kits are available for order.



An ADA Compliant Solution

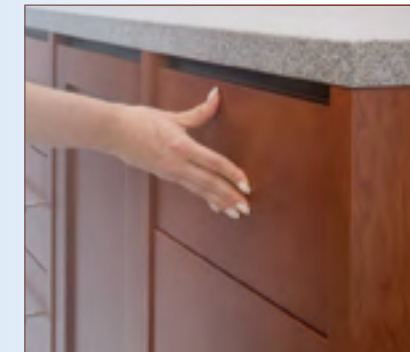

Public sector projects have design requirements specific to the needs of disabled persons; and those guidelines include the maximum pull force allowable for the opening of drawers.

Most slides with closing features involve spring tensioning to pull drawers closed. Generally, this means the pull force needed to override that tension is too great to meet ADA requirements.

Here's an alternative solution: Model 3832 Touch Release. With this product, drawers are held in a closed position

until the drawer front is pressed inward. This action releases the slide latch and the drawer is propelled open about two inches—eliminating pull force concerns and the need for knobs or handles. In aging-in-place or assisted living facility projects, end users do not have to grasp a pull or knob to open drawers, an operation that can be difficult or painful for those with arthritis or other disabilities.

From an aesthetic perspective, getting rid of handles gives cabinets a clean and contemporary appearance, whether drawers are of an overlay construction or flush with the cabinet face.

Another benefit of model 3832TR is that it affords full use of your space when installed in shallow toe-kick drawers in the base of cabinets. Because of the touch release feature, drawers can be opened with a nudge of the foot.

To learn more about this product, go to: <http://bit.ly/3832TR>.

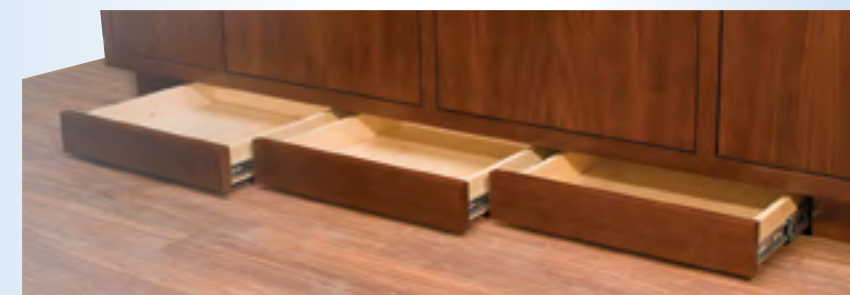

Here's a clever application: a medicine cabinet that pops out to the side. The touch release action is a perfect solution for this unique installation.



The Real Steel Deal

Have you ever looked through a catalog, poured over the photos, read and re-read glowing descriptions to get a sense of a product, but despite your study, feel as though you don't have enough information to make a decision? Well, if the product you're considering is a slide, and words and pictures won't do the trick, it's time to consider requesting a sample. Seeing a slide in the flesh, or the real steel as we like to say, can help with the decision-making process.

Making a Case

Say you've carefully scrutinized the specifications of the 3832 Easy-Close slide and believe it is the perfect fit for a particular project—but you can't seem to convince your client it is the right choice. A sample of the product—or better yet—a sample installed in the intended application where the soft-close action may be seen and felt might be the best way to convince your customer of the slide's value.

Send Me a Million

Although Accuride is known for their generous sample program, as with anything, there are limitations. We ask that you limit your sample requests to a maximum of five products. Only one pair per model may be requested.

Try Before You Buy

Samples are a convenient way to test out a product before making the larger commitment of using it throughout a project. Samples also provide the opportunity to break out of a routine and try something new without risk. If you've specified the same slide for years, but hesitated to make a change, this is your chance to test out a new solution.

Let's Get This Party Started

For more information, contact our Architectural Support Line at 888-459-8624. Our Marketing Architectural Coordinator, Christina can answer product or specification questions, offer slide recommendations based on your application requirements, and process your sample request.

NEWS BITES



Download Details

Did you know you could download CAD drawings from our web site? It's a cinch. Just click on the Downloads tab located on each specific product page or go to <http://bit.ly/AccurideCADs>, where you will find a complete list of the 2D (.dxf) and 3D (.igs) files available.



Tout Your Talent

Have you wrapped up a recent project you're especially proud of and you'd like to share it? We're always looking for success stories that include Accuride slides—especially when used in unusual applications. Contact us at archinfo@accuride.com, tell us a little bit about your project, and send a few photos. If your project is selected,

we'll showcase your accomplishment in our online and print communications.



Getting Social

In case you haven't heard, we've jumped on the social media bandwagon and we'd love to have you join us. We've set up market-specific pages so you can follow (and comment on) the information most meaningful to you.

Facebook: <http://bit.ly/accuridearch>

Twitter: <http://twitter.com/accuridearch>



Special Delivery

Stay in touch with what's hot and what's new from Accuride. We'll never spam you or overload you with e-mails—promise! You'll only receive something about once a month. Click on the "News from Accuride" icon here: <http://bit.ly/AccuNews> to sign up today.

An Over-the-Top Option

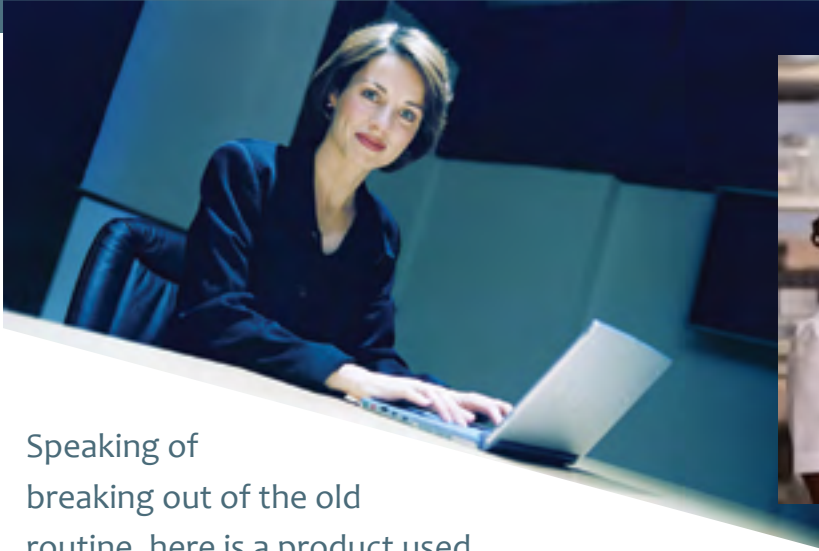

Speaking of breaking out of the old routine, here is a product used mainly in commercial office furniture, however it has the potential to enhance dozens of other applications in other industries.

Meet the Easy-Down®

Also known as Model 1155, these Flipper Door Slides® allow cabinet doors to be lifted and slid back over the top of the storage space. That over-the-top action keeps doors out of the way, while providing full access to contents. It's nicknamed the Easy-Down because of the product's hydraulic dampeners that slow closure to prevent bonked heads and squished fingers.

Expand Your Space Solutions

Designed for use in overhead storage units in a wealth of environments, the Easy-Down slides provide safer access and expand use of overhead space. In living spaces, the Easy-Down slides can be used in kitchens, laundry rooms, bedrooms, hobby rooms, garages, and more. Increase your storage in commercial buildings, retail stores, or medical facilities such as nursing homes, hospitals, or hospices, while eliminating the hazard of banging doors.

For more information and detailed specifications, visit <http://bit.ly/1155ch>.



The hydraulic cylinder slows the rate of closure to a safe speed.



Specs at a Glance

- Loads up to 30 lbs. per pair
- Accommodates door widths up to 48"
- Even lengths 12"–24"
- Clear zinc or black finish
- Over-the-top design provides no loss of normal storage space
- Protects user from rapid drop of door
- Door closing speed remains similar on both light and heavy doors.
- Cylinder cover cap provides a finished look (not shown).



File under E for Electronic

If you prefer to read your newsletter on line or want to refer back to articles down the road, long after this paper has been recycled, then bookmark <http://bit.ly/2012Newsletter>. You'll find a link to download the PDF for this issue there.

If you no longer wish to receive this newsletter, please contact us at archinfo@accuride.com.

Accuride

12311 Shoemaker Avenue
Santa Fe Springs, California 90670
(562) 903-0200 • www.accuride.com